

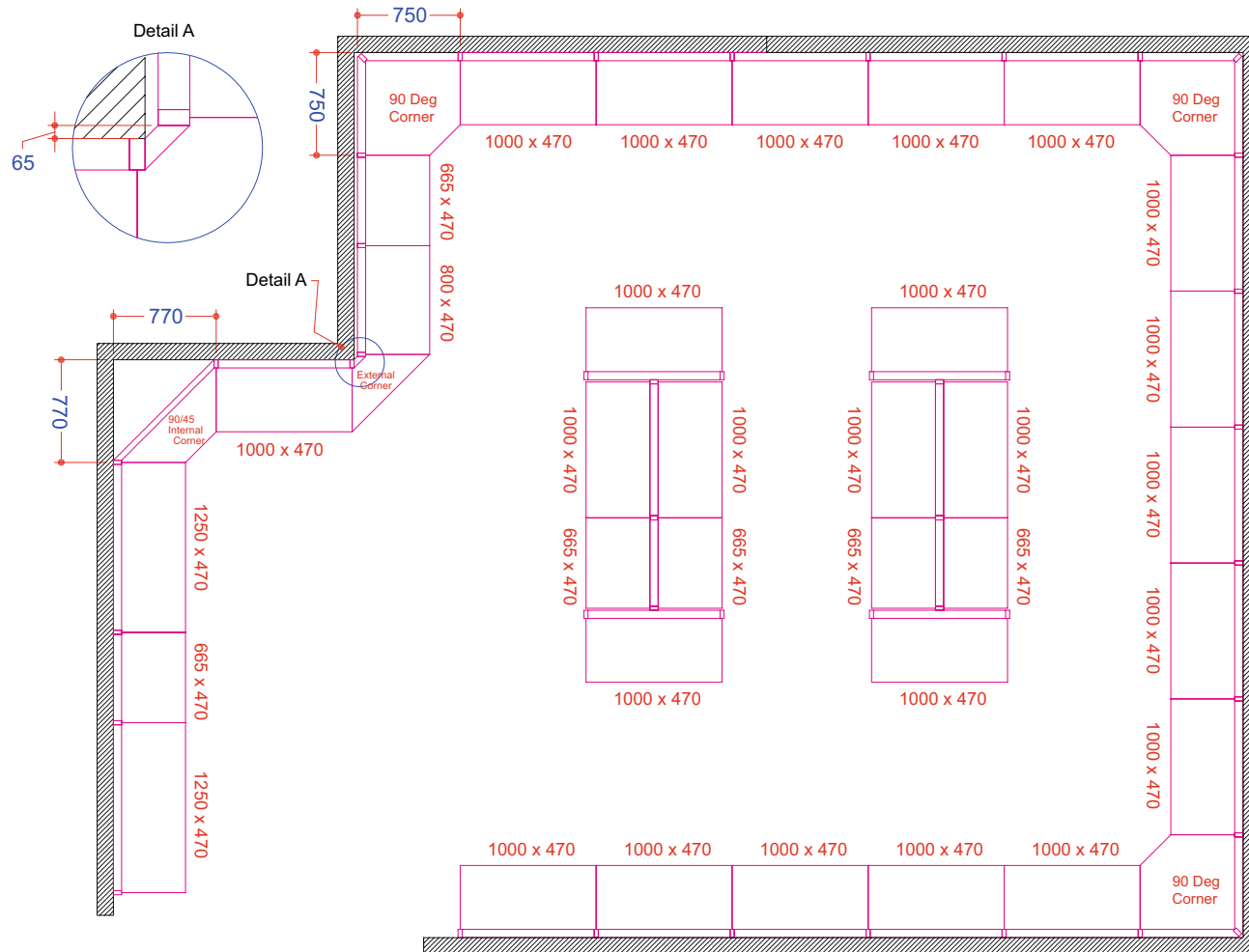

Technical Information

Shelving Floor Plan



Weight Loadings

- 3 The specified loads assume even distribution of product.
- 3 Wall fixing brackets will increase the weight loading considerably assuming the fixings are adequately secure.
- 3 Shelves must be installed in diminishing sizes as they ascend up the upright.

2. Wall Shelving Bays and Gondolas (Total Permissible Load of all shelves excluding base leg)

| MEAN DEPTH 370MM | |
|-------------------|-----------------------------|
| Upright Size (mm) | Total Permissible Load (Kg) |
| 60x30 | 250 |
| 80x30 | 400 |
| 110x30 | 600 |

RAL Codes

Standard Shelving Colours



RAL 9001
Jura White



RAL 9006
Silver

Plinth & Ticket Moulding Colours



RAL 9001
Jura White



RAL 9006
Silver



RAL 3020
Red



RAL 9005
Black



Clear/
Transparent



RAL 7015
Dark Grey



RAL 5002
Blue



RAL 6024
Green

Back Panel Breakdown for 160 Base Leg (Plain back panels only)

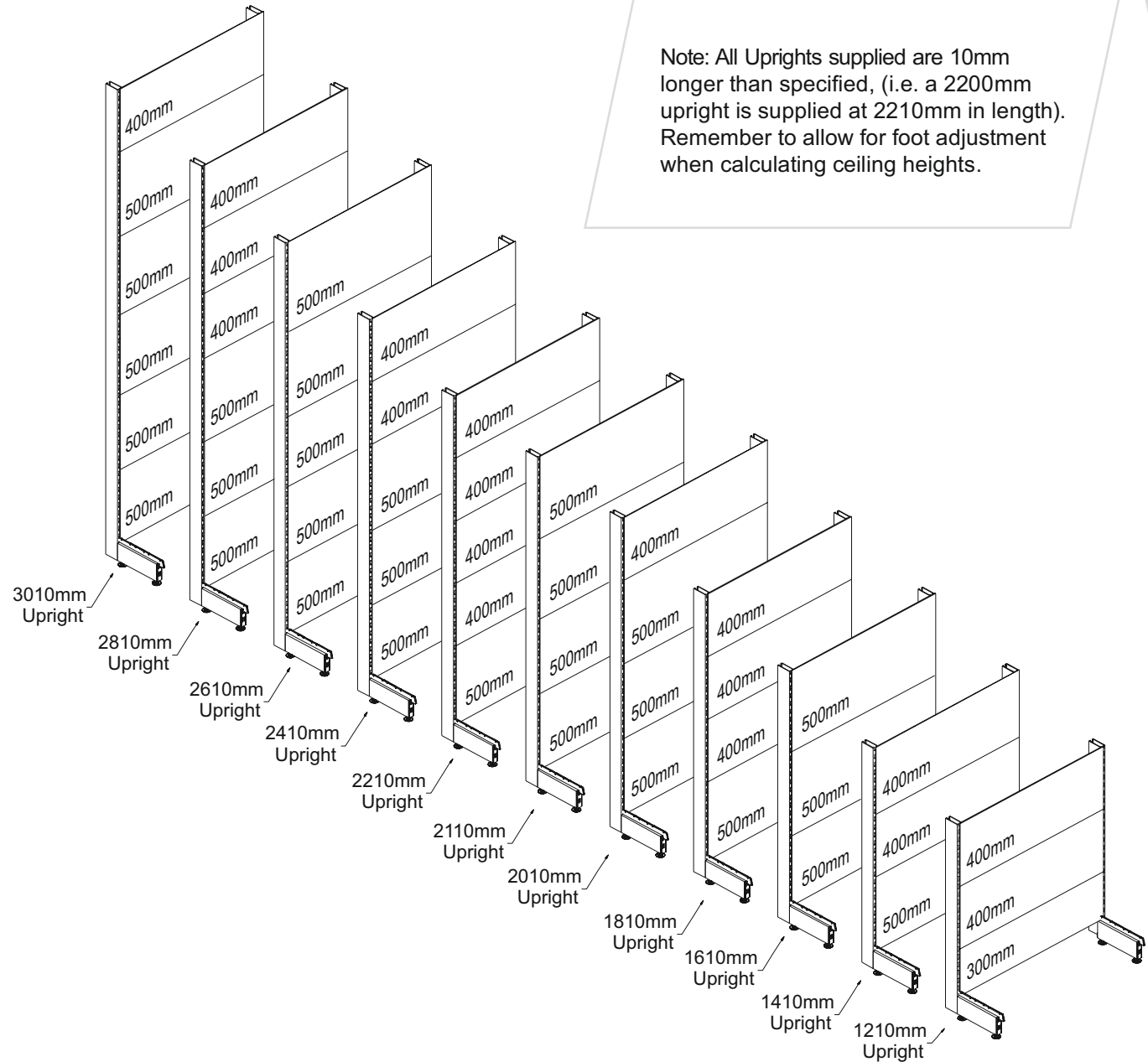

1. Shelves on Brackets or Base legs (Permissible Load per shelf)

| BRACKET TYPE | BRACKET | | | | | | BRACKET HEAVY DUTY | | | |
|----------------------|------------------------|-----|-----|-----|-----|-------------------|--------------------|-----------------------|-----|-----------------------|
| | 2 HOOK ADJUSTABLE | | | | | 3 HOOK ADJUSTABLE | | 3 HOOK NON ADJUSTABLE | | 4 HOOK NON ADJUSTABLE |
| Shelf Depth (mm) | 200 | 250 | 300 | 370 | 470 | 470 | 570 | 570 | 670 | 770 |
| AXIAL DISTANCE (mm) | PERMISSIBLE LOADS (kg) | | | | | | | | | |
| 665 | 130 | 120 | 110 | 100 | 90 | 170 | 150 | 180 | 160 | 200 |
| 1000 | 130 | 120 | 110 | 100 | 90 | 170 | 150 | 180 | 160 | 200 |
| 1250 | 130 | 120 | 110 | 100 | 90 | 170 | 150 | 180 | 160 | 200 |

| BASELEG TYPE | BASELEG HEIGHT: 160mm | | | | |
|----------------------|------------------------|-----|-----|-----|-----|
| | Shelf Depth (mm) | 370 | 470 | 570 | 670 |
| AXIAL DISTANCE (mm) | PERMISSIBLE LOADS (kg) | | | | |
| 665 | 230 | 290 | 350 | 450 | 360 |
| 1000 | 200 | 290 | 310 | 350 | 290 |
| 1250 | 155 | 260 | 270 | 310 | 270 |

3 In the case of loads on two sides (gondolas) the same loads as for wall shelving may be applied on each side.

| MEAN DEPTH 470MM | |
|-------------------|-----------------------------|
| Upright Size (mm) | Total Permissible Load (Kg) |
| 60x30 | 200 |
| 80x30 | 350 |
| 110x30 | 500 |

| MEAN DEPTH 570MM | |
|-------------------|-----------------------------|
| Upright Size (mm) | Total Permissible Load (Kg) |
| 60x30 | 150 |
| 80x30 | 300 |
| 110x30 | 450 |

| MEAN DEPTH 670MM | |
|-------------------|-----------------------------|
| Upright Size (mm) | Total Permissible Load (Kg) |
| 80x30 | 250 |
| 110x30 | 400 |

| MEAN DEPTH 770MM | |
|-------------------|-----------------------------|
| Upright Size (mm) | Total Permissible Load (Kg) |
| 80x30 | 200 |
| 110x30 | 400 |